



www.snabb.us

Installation Instructions for:

High flow intake kit (HFI-P3T6)

For Volvo 3.0L T6, R-design, and Polestar
S60, XC70, V60, XC60, V70, S80 T6

<p>Equipment/tools needed:</p> <p>1/4" drive ratchets 7mm Metric socket Ratchet Extensions T25 and T15 Torx Bits Metric hex wrenches</p>	<p>HARDWARE CONTINUED</p> <p>(1) Aluminum heatshield (1) Billet aluminum sensor housing (1) 3" Inlet Dryflow airfilter (1) rubber seal</p> <p>Hardware kit 2 (Airbox grommet hardware) (1) M6 Santoprene washer (1) M6 x 20mm flange bolt (black oxide) (1) .375" ID washer (black oxide) (1) LDPE spacer 5/16" (black) (1) M6 flange nut (black oxide)</p> <p>Hardware kit 3 (MAF bracket hardware) (1) M8 flange nut (black oxide) (2) M8 x 16mm flange bolt (black oxide)</p>
<p>HARDWARE</p> <p>Hardware kit 1 (airbox L bracket hardware) (2) M6 x 30mm flange bolt (black oxide) (1) M6 x 20mm flange bolt (black oxide) (3) M6 flange nut (black oxide) (2) LDPE spacer 5/8" (black) (3) M6 Santoprene washer (2) M6 Nylon washer (black)</p>	

REMOVAL

Removal of Stock Airbox

- Using a 7mm socket loosen the clamp on turbo inlet pipe to airbox lid but do not try to remove pipe from airbox lid.
- Remove (4) T25 torx screws from the lid of the airbox, then remove the lid, pulling up and away to separate from the turbo intake

See pictures below, next page...



- Disconnect the electrical connector from the air mass sensor in the airbox lid, then remove the 2 (T15) screws from sensor to remove it from the lid. Put the air mass sensor aside for reinstallation into the new kit.
- Grab a hold of the lower section of airbox and pull up and out of the engine bay. The fresh air pipe that attaches to the radiator support should pull out with the airbox.



- Remove the rubber and plastic foot from the lower frame rail bracket. **REMOVE THE RUBBER GROMMET ON THE BACK OF THE AIRBOX AND SET ASIDE**, you will need it in next step.

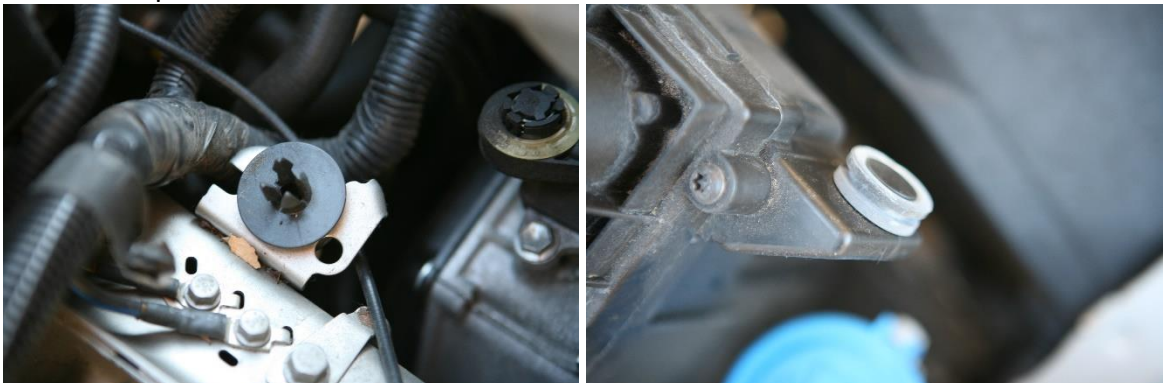

INSTALLATION OF HEATSHIELD AND MAF

- Heat shield lower rubber grommet gets installed first. Install the grommet in the same position and orientation as the stock airbox with the grommet protruding to the rear or the car. See pics below.
 - Put one santoprene washer over the M6x 20mm bolt and slide the bolt through the hole on the bottom rear corner of box so the bolt HEAD faces the front of the car.
 - Slide the 5/16" long LDPE spacer over the threads of the bolt, then **RE-USING the rubber grommet that was removed from the airbox slide the grommet over the LDPE spacer**, and finally the .375" ID black oxide washer and M6 nut to tighten the assembly down. (rubber grommet not shown in picture below right)



Heat shield L bracket (*w/ three holes*) & heatshield installation:

- The L bracket has to be attached to the car first (see picture below and on the left). Once it is attached to the car the airbox can be attached to the bracket using included hardware. **Attach** the L bracket to the hole shown below using [1] M6x20mm bolt, [1] rubber washer (to protect the finish on the bracket) and [1] M6 nut.
- Next drop the heatshield into place, centering the rubber grommet into the same slot on the frame that the stock airbox uses next to the windshield washer fill. Below right.

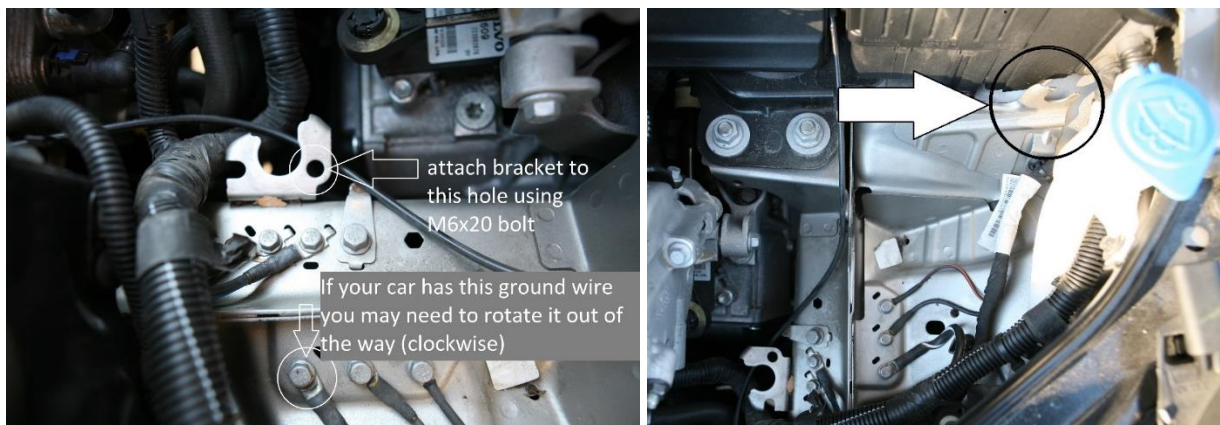



Once the airbox is in place, use the remaining L bracket hardware (Kit 1) to attach bracket to airbox: See pics Above.

- To assemble, put one santoprene washer over the M6 x 30mm bolt(s) and slide the bolt(s), lower bolt first, through the holes on the bracket facing the airbox.
- Slide the 5/8" long LDPE spacer between the airbox and over the threads of the M6 x 30mm bolt. Guide the bolt through the airbox hole, then slide the M6 nylon washer over followed by the M6 nut, then tighten the assembly down.

See pictures below for assembly order

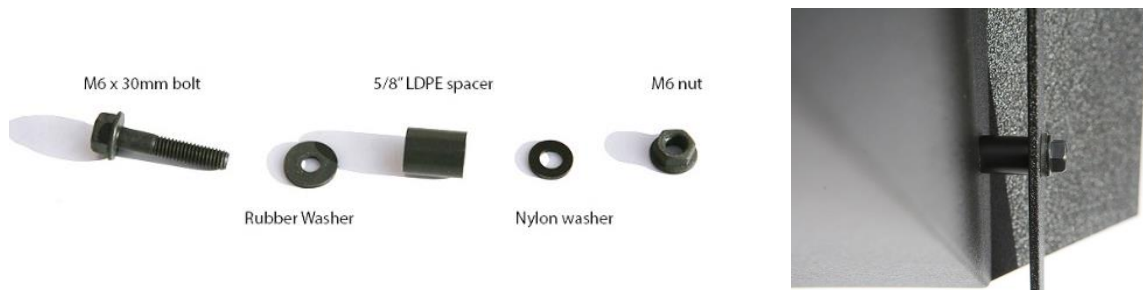

At this point the heatshield is installed and should be secured to the vehicle.

Install the air mass sensor into the sensor housing.

- The sensor can only be installed in one direction. Use the included thumb screws with internal hex to secure the sensor to the housing, tighten down with hex wrench
- Attach sensor housing bracket to the cars frame using the M8 x 16mm flange bolt and the M8 nut. The bracket gets attached with the L secured to the MAP housing and the straight section attached to the frame as shown in the pictures below. The hole is on the vertical section of the transmission support just under the two large nuts that secure the transmission mount the car (below the battery tray)



- Attach sensor housing onto upper part of the bracket using M8 bolt- adjust position if needed and don't forget to plug the sensor back in!



- Attach the airfilter to the sensor housing , then attach intake pipe to sensor housing and tighten down both clamps.



Enjoy your purchase!
Kristian Woodall
Snabb Performance Parts